

GBC FORWARD!



LOOKING FORWARD PREPARING FOR OUR FUTURE

2026 SOCIAL HALL RENOVATION PROJECT



GARDENA BUDDHIST CHURCH
1517 166th St, Gardena, CA 90247
GBCForward@gardenabuddhistchurch.org 310-327-9400

GARDENA BUDDHIST CHURCH

SOCIAL HALL RENOVATION PROJECT

WE NEED YOUR HELP

3 YEAR GOAL
\$2 MILLION



FOYER RENDERING



SOCIAL HALL RENDERING

PROJECT DESCRIPTION

In preparation for the 2026 100th Anniversary and the future, we have initiated a major renovation of the Social Hall. The current GBC Social Hall was completed nearly 50 years ago in 1978. This remodel will include an updated kitchen to obtain LA County Health Department certification and full compliance with the Americans with Disability Act (ADA) in our main hall, restrooms, and parking area.

The goal of this project is to not only comply with current health and safety regulations but to provide a safe and healthy environment for all those who use this facility – our Sangha and beyond – for the next 50 years.

THE RENOVATION WILL INCLUDE:

- **Kitchen** with a refinished floor, new lighting, new stainless steel counters with cabinets, new shelving, rice cooker vent, multiple hand washing stations, new energy efficient appliances but with the exception of the existing rice cookers, gas burners and recently repaired range.
- **Foyer** with a new flooring, lighting and paint.
- **Social Hall** with refinished floor, new stage lift, stage curtains, wall treatment, acoustic ceiling, lighting and paint.
- **Cooling Room** with refinished floor, new cabinets, sinks, washer/dryer, ceiling, lighting and paint.
- **Women's and Men's restrooms** with new flooring, fixtures, partitions, lighting and paint.

FORWARD TO THE FUTURE

GBC Forward! is the name of our remodeling project fundraising campaign. Our three-year goal is to raise \$2 million dollars. Please help us reach our goal. We are asking everyone to give generously to this vital facility improvement. Donations can be made as a one-time gift or made in installments over the campaign's three-year period. Receipts will be sent for any donations over \$100. Donor's cumulative donations (summed over the 2025-2027 campaign) will be acknowledged in donation levels and published in the Megumi, our temple newsletter. Should excess funds be collected, these will be set-aside for future facility improvement projects.

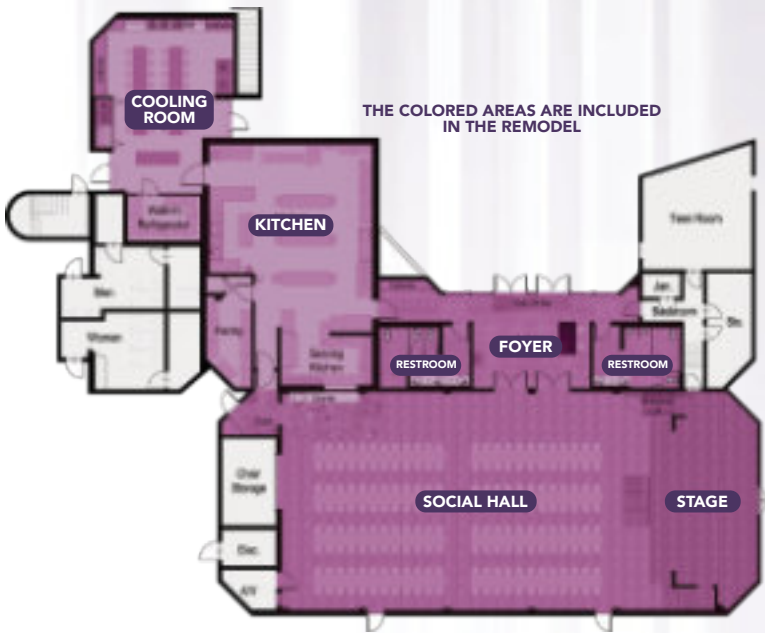

NOTE: THESE RENDERINGS / DRAWINGS ARE AN ARTISTIC INTERPRETATION OF A DESIGN CONCEPT. THE FINISHED REMODEL MAY NOT BE EXACT TO THESE RENDERINGS.